

Charger Accessories



BHS offers the most comprehensive line of products and accessories for use with battery chargers. BHS Charger Accessories offer practical solutions for charger storage and cable management. *(Chargers not included)*

Charger Stand

Charger Stands come in several models and provide a safe, convenient location for battery chargers.

Features & Benefits

- Heavy duty frame construction for added reliability
- Custom built models made to your specifications
- Fluid corners on the charger shelf increase product longevity
- CR-1 Cable Retractor mounting holes
- SB connector mounting holes
- Charger anchoring slots for securing most makes of chargers
- Charger shelves come slotted, allowing for optional 6" (152 mm) shelf extension



Fluid corners



CS-36

Available Models

Model	Shelf Width (X)	Shelf Capacity
CS-24	24" / 610 mm	400 lb / 181 kg
CS-36	36" / 914 mm	400 lb / 181 kg
CS-72	72" / 1829 mm	600 lb / 272 kg

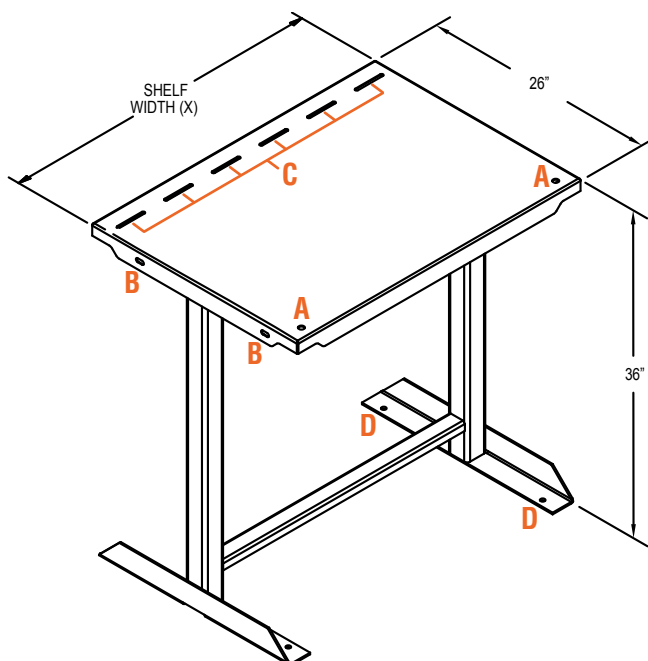

- A.** CR-1 Cable Retractor Mounting Holes
- B.** Shelf Extension Slots, 6" (152 mm) shelf extension is optional
- C.** Charger Anchoring Slots (secures most makes of chargers)
- D.** Floor Anchoring Hole

Multi-tier Charger Stand

Multi-tier Charger Stands come in several models and provide a safe, convenient location for storing battery chargers.

Features & Benefits

- Heavy duty frame construction for added reliability
- Custom built models made to any specifications
- Charger anchoring slots for securing most makes of chargers
- 800 lb (363 kg) capacity per shelf

Available Models

Model	Shelf Width	Depth	Height
CS-36-2TIER	36" / 914 mm	30" / 762 mm	47" / 1194 mm
CS-72-2TIER	72" / 1829 mm	30" / 762 mm	47" / 1194 mm
CS-84-2TIER	84" / 2134 mm	30" / 762 mm	47" / 1194 mm
CS-72-3TIER	72" / 1829 mm	30" / 762 mm	86" / 2184 mm
CS-72-4TIER	72" / 1829 mm	30" / 762 mm	125" / 3175 mm



CS-72-3TIER

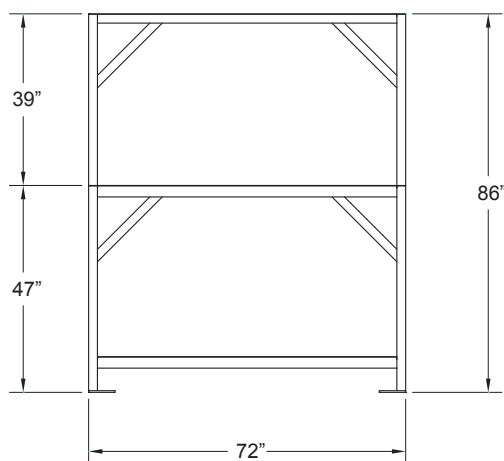
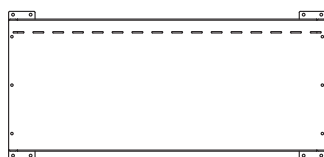

CS-72-3TIER

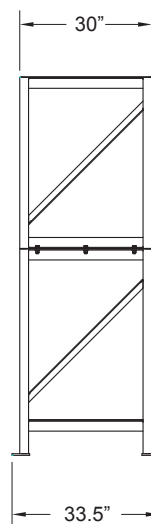

Dual Charger Stand Kit

The Dual Charger Stand Kit (CS-VHK) is designed to mount two wall-mount chargers, either back-to-back or side-by-side.

Features & Benefits

- Heavy duty frame construction
- Stand anchors securely to the floor
- 70" (1778 mm) overall height including Cable Retractors

Contents

- Dual charger stand
- (2) Cable Retractors
- (4) Floor anchors
- (2) Long crossbars – for side-by-side mounting of chargers
- (4) Short crossbars – for back-to-back mounting of chargers



CS-VHK

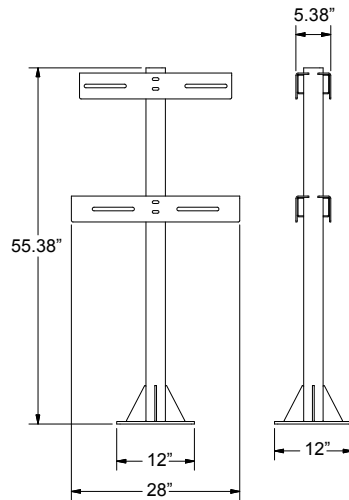

Back-to-back mounting

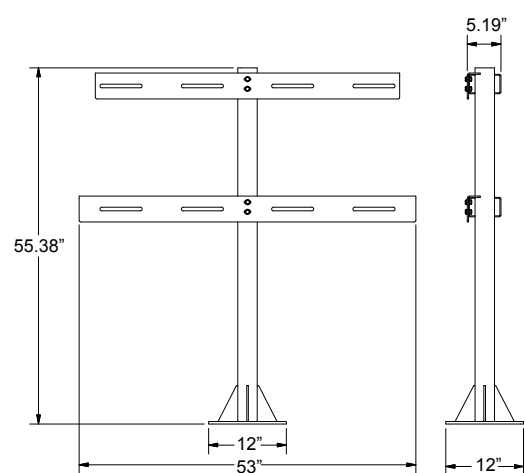

Side-by-side mounting

Product Specifications

	CS-VHK Back-to-back	CS-VHK Side-by-side	CS-VHK-4
Overall Width	28" / 711 mm	53" / 1346 mm	53" / 1346 mm
Overall Height	55.38" / 1407 mm	55.38" / 1407 mm	55.38" / 1407 mm
Overall Depth	12" / 305 mm	12" / 305 mm	12" / 305 mm



CS-VHK-4

Quad Charger Stand Kit

The Quad Charger Stand Kit (CS-VHK-4) is designed to mount four wall-mount chargers.

Features & Benefits

- Heavy duty frame construction
- Stand anchors securely to the floor
- 70" (1778 mm) overall height including Cable Retractors

Contents

- Dual charger stand
- (4) Cable Retractors
- (4) Floor anchors
- (4) Long crossbars – for side-by-side mounting of chargers on the front and back

Vertical Charger Stand

Vertical Charger Stands are available in three models, providing a safe, convenient location for vertical mount chargers.

Features & Benefits

- Heavy duty frame construction for added reliability
- Designed and built specifically for vertical mount chargers
- Available mounting for up to three chargers
- Convenient, space saving solution

Available Options

ARM (CS-VMP-ARM)

Arm allows charger cables to be routed over a battery stored on a BSXX-1 battery stand, and provides a convenient location for SB mount and connection

Note: Not available on CS-VMP-1

Available Models

Model	Overall Depth w/o Arm	Overall Width at Top	Overall Width at Base	Overall Height	Shipping Weight
CS-VMP-1	28" / 711 mm	11" / 280 mm	16.75" / 425 mm	47.13" / 1197 mm	55 lb / 25 kg
CS-VMP-2	28" / 711 mm	11" / 280 mm	16.75" / 425 mm	80" / 2032 mm	87 lb / 40 kg
CS-VMP-3	28" / 711 mm	11" / 280 mm	16.75" / 425 mm	112" / 2845 mm	109 lb / 50 kg



CS-VMP-2 shown with optional
Arm and Battery Stand



CS-VMP-2

Vertical Charger Mount

The Vertical Charger Mount (CS-KW) is typically mounted to the floor but can be mounted to a charger stand or racking to elevate chargers.

Features & Benefits

- Heavy duty frame construction for added reliability
- Charger anchoring slots for securing most makes of chargers
- Small footprint frees up valuable warehouse space

Available Models

Model	Overall Depth	Overall Width	Overall Height	Shipping Weight
CS-KW-1	12.125" / 308 mm	16.375" / 416 mm	42" / 1067 mm	29 lb / 13 kg
CS-KW-2	12.125" / 308 mm	16.375" / 416 mm	85" / 2159 mm	58 lb / 26 kg



CS-KW-1



CS-KW-2

Charger Wall Bracket

The Charger Wall Bracket (CWB) offers an economical solution for mounting battery chargers. The CWB is sturdy and easy to install.

Features & Benefits

- Helps prevent charger damage
- Frees up valuable floor space
- Supports up to 400 lb (181 kg) when mounted on a wall with sufficient bearing strength
- 24.13" (613 mm) deep x 24.13" (613 mm) tall



CWB

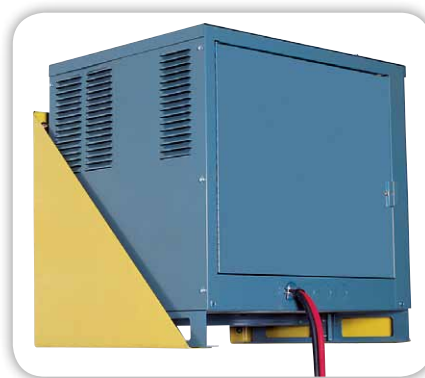

Mounted CWB with charger

High Frequency Charger Wall Bracket

The Charger Wall Bracket (CWB-V1) offers an economical solution for mounting high frequency battery chargers. The CWB-V1 is sturdy and easy to install.

Features & Benefits

- Helps prevent charger damage
- Frees up valuable floor space
- 14" (356 mm) deep x 12" (305 mm) tall
- 9" (229 mm) storage width allows proper ventilation for 7" (178 mm) wide charger



CWB-V1

Cable Retractor

The Cable Retractor (CR-1) utilizes a heavy duty spring with safety chain for added protection and includes a cable clamp to suspend the cables. The CR-1 mounts to the shelves of BHS Battery Stands or Charger Stands using pre-drilled mounting holes or to BHS Charger Wall Brackets using a Cable Retractor Mounting Bracket (sold separately).

Features & Benefits

- Heavy duty spring with safety chain
- Threaded mounting stud with nut
- Supports up to 10' (3 m) of 2/0 charger leads
- 34" (864 mm) long x 1" (25 mm) diameter pole



CR-1



CR-1 mounted on Charger Stand

Cable Retractor Mounting Bracket

The Cable Retractor Mounting Bracket (CR-MT) allows the BHS Cable Retractor (CR-1) to be mounted on a Charger Wall Bracket (CWB).

Features & Benefits

- Mounts to BHS Charger Wall Brackets by way of (4) 0.31" (8 mm) diameter mounting holes
- Mounting hardware included



CR-MT



CR-MT shown mounted on CWB with CR-1

Magnetic Cable Mount

The Magnetic Cable Mount (CR-M) is a convenient tool that safely secures battery and charger cables, preventing cable damage and clutter. The CR-M mounts to any flat, ferrous metallic surface such as a Charger Stand, Charger Wall Bracket, or charger case.

Features & Benefits

- 3.25" (83 mm) diameter magnet mounts to any flat, ferrous metallic surface
- Allows precise positioning of cable and connector
- Intended for two standard battery cables
- Supports up to 10' (3 m) of 2/0 charger leads
- Magnet housing is constructed of durable chrome plated steel
- HDPE acid resistant clamp



CR-M



CR-M attached to CWB

Heavy Duty Cable Retractor

The Heavy Duty Cable Retractor (CCR-12HD) holds larger cables and is adjustable and lightweight. The CCR-12HD mounts to BHS Battery Stands, Charger Stands, or Charger Wall Brackets by way of (2) 0.38" (10 mm) diameter mounting holes.

Features & Benefits

- Bolts to charger bracket or charger shelf
- Adjustable tension spring
- Reaches up to 10' (3 m)
- Supports up to 12' (3.66 m) of 4/0 charger leads
- HDPE acid resistant clamp



CCR-12HD



CCR-12HD mounted on CWB

